







K-Suite™

Single-Serve Hospitality Brewer

KEURIG
COMMERCIAL

-  Pour fresh water for each brew; no standing water
-  Brew any size from 6-8 oz.
-  Easy-to-clean surfaces
-  Cord storage eliminates clutter
-  Fits most travel mugs, thanks to a removable drip tray
-  Auto-Off feature saves energy



Designed for hospitality use

Features

Brew Sizes	6 oz. - 8 oz.
Water Source	Pour-over
Cold Water Tank	6 oz. - 8 oz.
Drainable Internal Water Tank	Yes - Manual
Interface	Button Control
- Language	English
- Programmable Auto Off	Yes
- Customizable Brew Temperature	No
- Customizable Brew Size Options	Yes

Specifications

Brewer Weight (Empty)	4.65 lbs.
UL Listed	cULus Hospitality/Household
Electrical	120 VAC, 60 Hz
Power	1470W
Plug Type	2-Wire Plus Ground
Order ID/GTIN	10611247381394
UPC Number	611247381397
Case Weight	6.5 lbs.
Case Dimensions	14.76" H x 5.79" W x 13.52" D

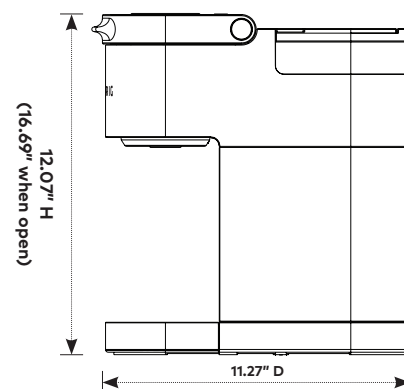
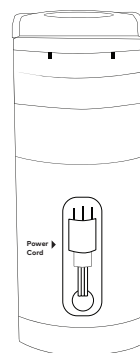
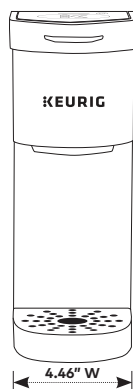

K-Suite™

Single-Serve Hospitality Brewer

KEURIG
COMMERCIAL

Designed for hospitality use

- 1 Lift**
handle and insert K-Cup® pod.
- 2 Place**
mug and close the handle.
- 3 Pour**
Pour 6 oz. - 8 oz. of water into
the reservoir. Push large button
to begin brew!

